

ПРОЕКТ

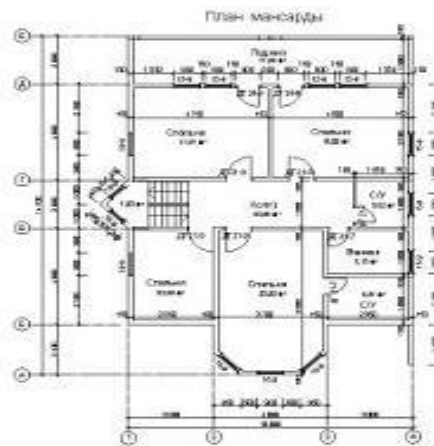

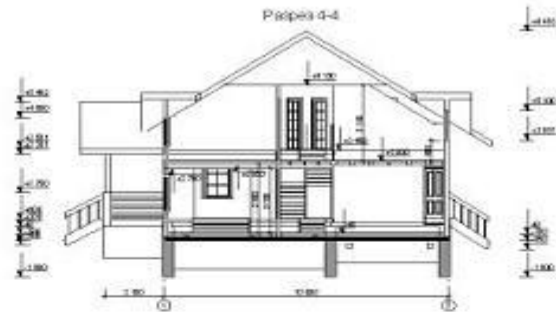

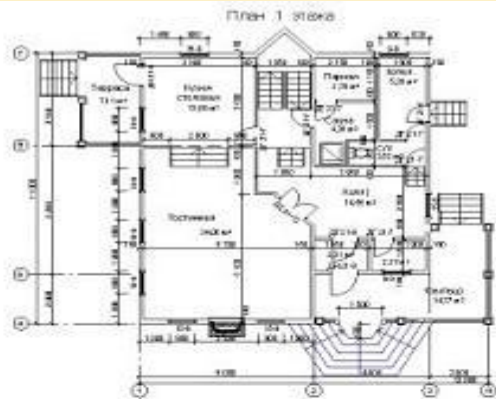







$40-5$



$32-2$



$12+8$



$45-7$



$77-17$



$34+16$



$56-12$



$25+3$



$63+8$



$$32-2$$



$$12+8$$



$$45-7$$



$$77-17$$



$$34+16$$



$$56-12$$



$$25+3$$



$$63+8$$



$$32-2$$



$$12+8$$



$$45-7$$



$$77-17$$



$$34+16$$



$$56-12$$



$$25+3$$





$$32-2$$



$$45-7$$



$$77-17$$



$$34+16$$



$$56-12$$



$$25+3$$





$$32-2$$



$$45-7$$



$$77-17$$



$$34+16$$



$$25+3$$





$$32-2$$



$$77-17$$



$$34+16$$



$$25+3$$





😊
32-2



◇
34+16

○
25+3





☺
32-2

○
25+3



Skazkinfo



32-2



AudioSkazkinfo



AudioSkazkinfo





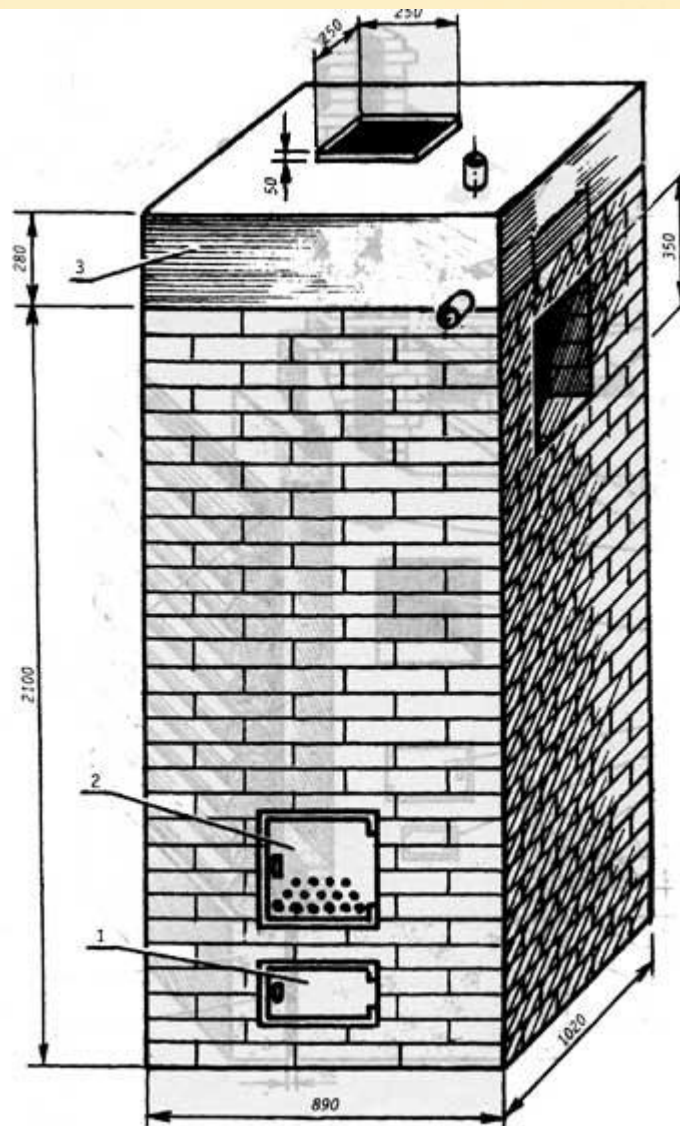

Рис. 5.2.2. Внешний вид печи-каменки: 1 – поддувало; 2 – топливник; 3 – бак для воды