

# THE HISTORY OF ARCHITECTURE

FROM PREHISTORIC TO MODERN TIMES



**The fifteenth Album:  
THE WESTERN EUROPEAN  
AND THE NORTH AMERICAN  
NEW TIMES ARCHITECTURE**



**Albums of characteristic examples for the Educational course**

**by Dr. Konstantin I.Samoilov**

Almaty, 2017

**This series of albums generated for information purposes of the Educational course "The General History of Architecture": 2 credits / 30 hours of lectures.**

Until the mid-19<sup>th</sup> century, examples are grouped by region. In this period, the phenomenon of a single world architectural process begins to manifest itself. Since the last third of the 19<sup>th</sup> century, examples have been grouped by decades.

**Thirty albums illustrate the following topics:**

- the 1<sup>st</sup> Album: EDUCATIONAL AND SCIENTIFIC-THEORETICAL SOURCES
- the 2<sup>nd</sup> Album: THE PREHISTORIC ERA'S ARCHITECTURE
- the 3<sup>rd</sup> Album: THE ANCIENT EGYPTIAN ARCHITECTURE
- the 4<sup>th</sup> Album: THE ANCIENT MESOPOTAMIAN ARCHITECTURE
- the 5<sup>th</sup> Album: THE ANCIENT GREEK ARCHITECTURE
- the 6<sup>th</sup> Album: THE ANCIENT ROMAN ARCHITECTURE
- the 7<sup>th</sup> Album: THE MEDIEVAL EUROPEAN ARCHITECTURE
- the 8<sup>th</sup> Album: THE EUROPEAN RENAISSANCE'S ARCHITECTURE
- the 9<sup>th</sup> Album: THE MEDIEVAL MAGHREB'S, THE NEAR EASTERN AND THE CAUCASUS'S ARCHITECTURE
- the 10<sup>th</sup> Album: THE MEDIEVAL CENTRAL ASIAN ARCHITECTURE
- the 11<sup>th</sup> Album: THE ANCIENT AND MEDIEVAL CHINESE ARCHITECTURE
- the 12<sup>th</sup> Album: THE MEDIEVAL SOUTHEASTERN AND EASTERN ASIAN ARCHITECTURE
- the 13<sup>th</sup> Album: THE MEDIEVAL CENTRAL AMERICAN ARCHITECTURE
- the 14<sup>th</sup> Album: THE EASTERN EUROPE MIDDLE AGES AND NEW TIMES ARCHITECTURE
- **the 15<sup>th</sup> Album: THE WESTERN EUROPEAN AND THE NORTH AMERICAN NEW TIMES ARCHITECTURE**

- the 16<sup>th</sup> Album: THE WORLD'S ARCHITECTURE OF THE 1870's
- the 17<sup>th</sup> Album: THE WORLD'S ARCHITECTURE OF THE 1880's
- the 18<sup>th</sup> Album: THE WORLD'S ARCHITECTURE OF THE 1890's
- the 19<sup>th</sup> Album: THE WORLD'S ARCHITECTURE OF THE 1900's
- the 20<sup>th</sup> Album: THE WORLD'S ARCHITECTURE OF THE 1910's
- the 21<sup>st</sup> Album: THE WORLD'S ARCHITECTURE OF THE 1920's
- the 22<sup>nd</sup> Album: THE WORLD'S ARCHITECTURE OF THE 1930's
- the 23<sup>rd</sup> Album: THE WORLD'S ARCHITECTURE OF THE 1940's
- the 24<sup>th</sup> Album: THE WORLD'S ARCHITECTURE OF THE 1950's
- the 25<sup>th</sup> Album: THE WORLD'S ARCHITECTURE OF THE 1960's
- the 26<sup>th</sup> Album: THE WORLD'S ARCHITECTURE OF THE 1970's
- the 27<sup>th</sup> Album: THE WORLD'S ARCHITECTURE OF THE 1980's
- the 28<sup>th</sup> Album: THE WORLD'S ARCHITECTURE OF THE 1990's
- the 29<sup>th</sup> Album: THE WORLD'S ARCHITECTURE OF THE 2000's
- the 30<sup>th</sup> Album: THE WORLD'S ARCHITECTURE OF THE 2010's

Examples are distributed in chronological order of the construct completion.

**Images sources are indicated directly near with illustrations on each page.**

Architects and companies listed on the basis of aggregate data from different sources (for some objects from various sources indicate different authors). About some buildings listed authors in the available sources has not yet been found.

The Author expresses his gratitude to Internet resources – <https://www.google.com> ; <https://www.wikipedia.org> – which to provide the ability to collect an information.

*The 15<sup>th</sup> Album's front cover:*

**The Metropolitan Cathedral of the Assumption of the Most Blessed Virgin Mary into Heaven, Mexico city, Mexico, 1573 / 1813**

**(Arch. Claudio de Arciniega) - [https://upload.wikimedia.org/wikipedia/commons/c/c6/Catedral de M%C3%A9xico.jpg](https://upload.wikimedia.org/wikipedia/commons/c/c6/Catedral_de_M%C3%A9xico.jpg)**

**The "Zwinger" palace, Dresden, Germany, 1728 / 1855 (Arch. Matthäus Daniel Pöppelmann / Gottfried Semper) –**

<http://abload.de/img/zwinger33ccrq6.jpg>

**The "Crystal Palace" - Great Exhibition's palace, London, United Kingdom, 1851(Arch. Joseph Paxton) –**

[http://images.adsttc.com/media/images/51d4/79f7/b3fc/4b9e/0f00/019b/large\\_jpg/800px-Crystal Palace - plan.jpg?1372879349](http://images.adsttc.com/media/images/51d4/79f7/b3fc/4b9e/0f00/019b/large_jpg/800px-Crystal_Palace_-_plan.jpg?1372879349)

**The United States Capitol, Washington, D.C., USA, 1800 / 1863 (Arch. William Thornton) –**

[https://upload.wikimedia.org/wikipedia/commons/thumb/a/a3/United States Capitol west front edit2.jpg/1920px-](https://upload.wikimedia.org/wikipedia/commons/thumb/a/a3/United_States_Capitol_west_front_edit2.jpg/1920px-United_States_Capitol_west_front_edit2.jpg)

[United States Capitol west front edit2.jpg](https://upload.wikimedia.org/wikipedia/commons/thumb/a/a3/United_States_Capitol_west_front_edit2.jpg/1920px-United_States_Capitol_west_front_edit2.jpg)

**Purpose of the 15<sup>th</sup> Lecture:**

To study the basic features of the Western European and the North American New Times architecture.

**Tasks of the 15<sup>th</sup> Lecture:**

- To consider characteristic examples of specifically organized spaces and buildings;
- To accentuate the features of construction depending on the availability of building materials;
- To emphasize the difference between cult and dwelling buildings.

**Tasks for the self-research work:**

1. Study the change in the nomenclature of buildings and structures during the evolution of the Mexican, USA's, German, French, British, Spanish New Times Architecture.
2. Analyze geometric parameters of main types of structures and buildings.

**Questions for the self-preparation:**

1. Accentuate the features of the USA's New Times architecture
2. Accentuate the features of the Mexican New Times architecture

**Themes of abstracts (16 pages, 40 000 characters, A4 format):**

1. The evolution of the British New Times Architecture
2. The evolution of the French New Times Architecture
3. The evolution of the German New Times Architecture

## **Examples for the 15<sup>th</sup> Lecture:**

- 15.1** The Metropolitan Cathedral of the Assumption of the Most Blessed Virgin Mary into Heaven, Mexico city, Mexico, 1573 / 1813 (Arch. Claudio de Arciniega)
- 15.2** The Palace of Versailles / Château de Versailles, Versailles, Île-de-France, France, 1682 (Arch. Louis Le Vau)
- 15.3** The "Sanssouci" palace, Potsdam, Germany, 1747 (Arch. Frederick the Great's sketches, Georg Wenzeslaus von Knobelsdorff)
- 15.4** The "Zwinger" palace, Dresden, Germany, 1728 / 1855 (Arch. Matthäus Daniel Pöppelmann / Gottfried Semper)
- 15.5** The Museo del Prado, Madrid, Spain, 1819 (Arch. Juan de Villanueva)
- 15.6** The L'église de la Madeleine / the Madeleine Church, Paris, France, 1823 (Arch. Pierre-Alexandre Vignon, Pierre Contant d'Ivry, Jacques-Marie Huvé, Guillaume-Martin Couture)
- 15.7** The Royal Pavilion, Brighton, United Kingdom, 1823 (Arch. John Nash, Augustus Charles Pugin, Henry Holland, William Porden)
- 15.8** The "Crystal Palace" - Great Exhibition's palace, London, United Kingdom, 1851 (Arch. Joseph Paxton)
- 15.9** The Palace of Westminster / the Houses of Parliament, London, United Kingdom, 1860 (Arch. Charles Barry, Augustus Welby Northmore Pugin)
- 15.10** The United States Capitol, Washington, D.C., USA, 1800 / 1863 (Arch. William Thornton)



## 15.1 The Metropolitan Cathedral of the Assumption of the Most Blessed Virgin Mary into Heaven, Mexico city, Mexico, 1573 / 1813 (Arch. Claudio de Arciniega)



Sources: [https://upload.wikimedia.org/wikipedia/commons/c/c6/Catedral\\_de\\_M%C3%A9xico.jpg](https://upload.wikimedia.org/wikipedia/commons/c/c6/Catedral_de_M%C3%A9xico.jpg); [https://doniqanmerritt.files.wordpress.com/2013/05/img\\_0018.jpg](https://doniqanmerritt.files.wordpress.com/2013/05/img_0018.jpg); [https://www.ecured.cu/images/c/c8/Claudio\\_de\\_Arciniega.jpg](https://www.ecured.cu/images/c/c8/Claudio_de_Arciniega.jpg)

## 15.2 The Palace of Versailles / Château de Versailles, Versailles, Île-de-France, France, 1682 (Arch. Louis Le Vau)

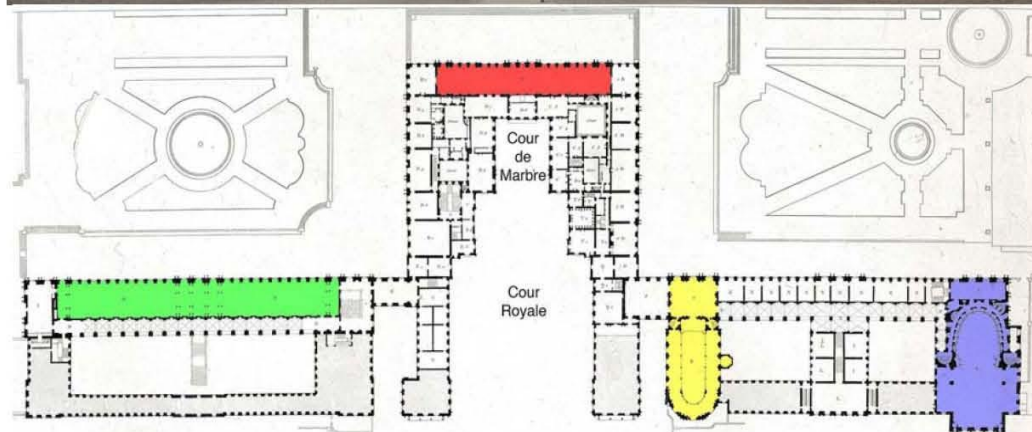

Sources: [https://upload.wikimedia.org/wikipedia/commons/thumb/b/be/Peter\\_Stehlik\\_2013.04.22\\_Panorama\\_1A.jpg/1920px-Peter\\_Stehlik\\_2013.04.22\\_Panorama\\_1A.jpg](https://upload.wikimedia.org/wikipedia/commons/thumb/b/be/Peter_Stehlik_2013.04.22_Panorama_1A.jpg/1920px-Peter_Stehlik_2013.04.22_Panorama_1A.jpg) ;  
[https://upload.wikimedia.org/wikipedia/commons/thumb/2/25/Plans\\_du\\_rez-de-chauss%C3%A9e\\_et\\_du\\_premier\\_%C3%A9tage\\_du\\_palais\\_de\\_Versailles%2C\\_%C3%89diteur\\_Gavard%2C\\_premier\\_%C3%A9tage\\_-\\_Gallica\\_2011\\_%28detail%2C\\_color-coded%29.jpg/1920px-Plans\\_du\\_rez-de-chauss%C3%A9e\\_et\\_du\\_premier\\_%C3%A9tage\\_du\\_palais\\_de\\_Versailles%2C\\_%C3%89diteur\\_Gavard%2C\\_premier\\_%C3%A9tage\\_-\\_Gallica\\_2011\\_%28detail%2C\\_color-coded%29.jpg](https://upload.wikimedia.org/wikipedia/commons/thumb/2/25/Plans_du_rez-de-chauss%C3%A9e_et_du_premier_%C3%A9tage_du_palais_de_Versailles%2C_%C3%89diteur_Gavard%2C_premier_%C3%A9tage_-_Gallica_2011_%28detail%2C_color-coded%29.jpg/1920px-Plans_du_rez-de-chauss%C3%A9e_et_du_premier_%C3%A9tage_du_palais_de_Versailles%2C_%C3%89diteur_Gavard%2C_premier_%C3%A9tage_-_Gallica_2011_%28detail%2C_color-coded%29.jpg) ;  
<https://upload.wikimedia.org/wikipedia/commons/thumb/a/a3/Versaillespanorama2.jpg/1920px-Versaillespanorama2.jpg> ;  
[https://upload.wikimedia.org/wikipedia/commons/thumb/e/e8/Cour\\_de\\_Marbre\\_du\\_Ch%C3%A2teau\\_de\\_Versailles\\_October\\_5%2C\\_2011.jpg/1280px-Cour\\_de\\_Marbre\\_du\\_Ch%C3%A2teau\\_de\\_Versailles\\_October\\_5%2C\\_2011.jpg](https://upload.wikimedia.org/wikipedia/commons/thumb/e/e8/Cour_de_Marbre_du_Ch%C3%A2teau_de_Versailles_October_5%2C_2011.jpg/1280px-Cour_de_Marbre_du_Ch%C3%A2teau_de_Versailles_October_5%2C_2011.jpg) ;  
[https://upload.wikimedia.org/wikipedia/commons/thumb/b/bc/Louis\\_Le\\_Vau.jpg/800px-Louis\\_Le\\_Vau.jpg](https://upload.wikimedia.org/wikipedia/commons/thumb/b/bc/Louis_Le_Vau.jpg/800px-Louis_Le_Vau.jpg)



### 15.3 The "Sanssouci" palace, Potsdam, Germany, 1747 (Arch. Frederick the Great's sketches, Georg Wenzeslaus von Knobelsdorff)



Sources: <https://upload.wikimedia.org/wikipedia/commons/1/1c/Sanssouci-Air.JPG> ; [http://img09.deviantart.net/97b0/v/2011/093/8/8/the\\_new\\_chambers\\_in\\_sanssouci\\_by\\_pingallery-d3d3lql.jpg](http://img09.deviantart.net/97b0/v/2011/093/8/8/the_new_chambers_in_sanssouci_by_pingallery-d3d3lql.jpg) ;  
[http://img11.deviantart.net/664f/i/2012/329/1/1/park\\_sanssouci\\_chinese\\_house\\_by\\_pingallery-d5m4g0x.jpg](http://img11.deviantart.net/664f/i/2012/329/1/1/park_sanssouci_chinese_house_by_pingallery-d5m4g0x.jpg) ;  
<https://cdn.getyourguide.com/niwziy2l9cvz/2l9qa84V9Vma2yqoSkWaCs/965deb538b5c403c02b085f8127a834e/sanssouci-potsdam-1500x850.jpg> ;  
<https://cdn.getyourguide.com/niwziy2l9cvz/4lqpyu16HemYqMOiwAeow4/e4c689acfa7880b1889aa052332397d0/sanssouci-potsdam-1500x850.jpg> ;  
[https://upload.wikimedia.org/wikipedia/commons/9/90/Friedrich\\_Zweite\\_Alt.jpg](https://upload.wikimedia.org/wikipedia/commons/9/90/Friedrich_Zweite_Alt.jpg) ; [https://upload.wikimedia.org/wikipedia/commons/8/8a/Georg\\_Wenzeslaus\\_von\\_Knobelsdorff\\_1738.jpg](https://upload.wikimedia.org/wikipedia/commons/8/8a/Georg_Wenzeslaus_von_Knobelsdorff_1738.jpg)



## 15.4 The "Zwinger" palace, Dresden, Germany, 1728 / 1855 (Arch. Matthäus Daniel Pöppelmann / Gottfried Semper)

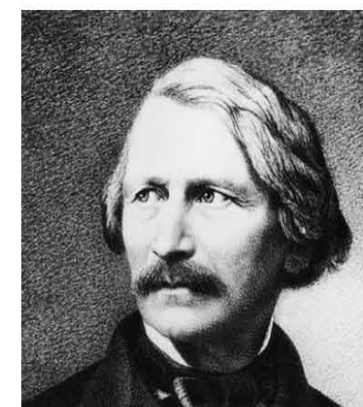

Sources: [http://drazdany.poznej.com/files/zwinger\\_4.jpg](http://drazdany.poznej.com/files/zwinger_4.jpg) ; <http://www.dresden-online.de/files/dresden-online/rubriken/kultur/sehenswuerdigkeiten/zwinger-dresden-bildpixel-pixelio.jpg> ;  
<http://abload.de/img/zwinger33ccra6.jpg> ; [http://www.goruma.de/export/sites/www.goruma.de/Globale\\_Inhalte/Bilder/Content/D/Deutschland Dresden Zwinger 1 1200.jpg](http://www.goruma.de/export/sites/www.goruma.de/Globale_Inhalte/Bilder/Content/D/Deutschland_Dresden_Zwinger_1_1200.jpg) ;  
[http://www.herford.de/media/custom/2044\\_1125\\_1\\_q.JPG?1422031826](http://www.herford.de/media/custom/2044_1125_1_q.JPG?1422031826) ; <https://upload.wikimedia.org/wikipedia/commons/7/7a/Gottfried-semper.jpg>

## 15.5 The Museo del Prado, Madrid, Spain, 1819 (Arch. Juan de Villanueva)

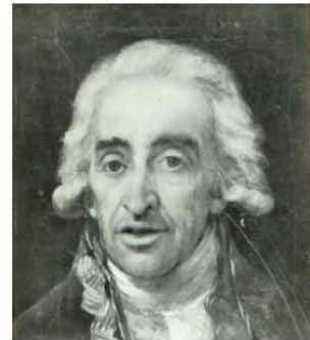

Sources: <http://www.intk.com/nl/organisaties/museo-nacional-del-prado/slideshow/01-DT%20PRADO%2015646620%20web.jpg>; [http://artista.s3.amazonaws.com/repository/0/4/0/8156\\_cuerpo1.jpg](http://artista.s3.amazonaws.com/repository/0/4/0/8156_cuerpo1.jpg); <http://cloud2.todocoleccion.net/libros-segunda-mano-arquitectura/tc/2014/09/11/11/45180262.jpg>



## 15.6 The L'église de la Madeleine / the Madeleine Church, Paris, France, 1823 (Arch. Pierre-Alexandre Vignon, Pierre Contant d'Ivry, Jacques-Marie Huvé, Guillaume-Martin Couture)

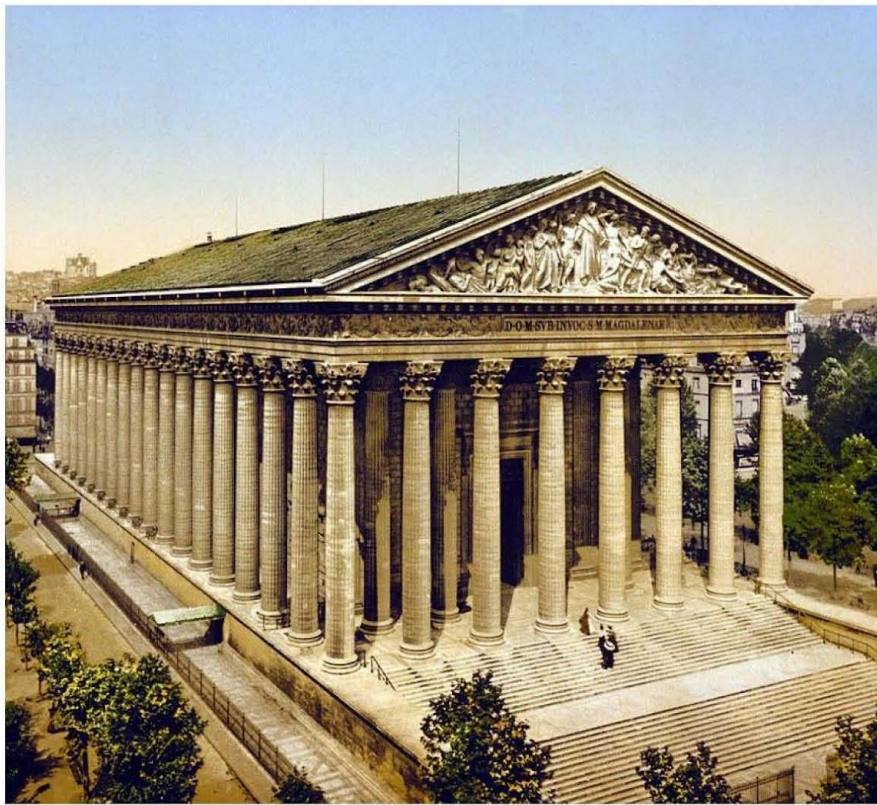

Sources: [https://upload.wikimedia.org/wikipedia/commons/thumb/e/e4/The\\_Madeleine%2C\\_Paris%2C\\_France%2C\\_ca.\\_1890-1900.jpg/1024px-The\\_Madeleine%2C\\_Paris%2C\\_France%2C\\_ca.\\_1890-1900.jpg](https://upload.wikimedia.org/wikipedia/commons/thumb/e/e4/The_Madeleine%2C_Paris%2C_France%2C_ca._1890-1900.jpg/1024px-The_Madeleine%2C_Paris%2C_France%2C_ca._1890-1900.jpg) ; [https://upload.wikimedia.org/wikipedia/commons/a/a7/Vignon,\\_Alexandre\\_Pierre.jpg](https://upload.wikimedia.org/wikipedia/commons/a/a7/Vignon,_Alexandre_Pierre.jpg) ; [https://upload.wikimedia.org/wikipedia/commons/thumb/c/c0/P1030420\\_Paris\\_VIII\\_%C3%A9glise\\_de\\_la\\_Madeleine\\_colonnes\\_fa%C3%A7ade\\_occidentale\\_rwk.JPG/800px-P1030420\\_Paris\\_VIII\\_%C3%A9glise\\_de\\_la\\_Madeleine\\_colonnes\\_fa%C3%A7ade\\_occidentale\\_rwk.JPG](https://upload.wikimedia.org/wikipedia/commons/thumb/c/c0/P1030420_Paris_VIII_%C3%A9glise_de_la_Madeleine_colonnes_fa%C3%A7ade_occidentale_rwk.JPG/800px-P1030420_Paris_VIII_%C3%A9glise_de_la_Madeleine_colonnes_fa%C3%A7ade_occidentale_rwk.JPG) ; <http://www.savoirs.essonne.fr/typo3temp/pics/7bedab0cea.jpg>



## 15.7 The Royal Pavilion, Brighton, United Kingdom, 1823 (Arch. John Nash, Augustus Charles Pugin, Henry Holland, William Porden)



Sources: <https://i.ytimg.com/vi/m3rWp4Dwhv0/maxresdefault.jpg> ; <http://www.oliverburns.com/wp-content/uploads/2016/09/Image-via-Fine-Art-America.jpg> ; [http://kevassets.timeincuk.net/inspirewp/live/wp-content/uploads/sites/8/2009/08/john\\_nash2.jpg](http://kevassets.timeincuk.net/inspirewp/live/wp-content/uploads/sites/8/2009/08/john_nash2.jpg) ; [https://upload.wikimedia.org/wikipedia/commons/c/cb/Augustus\\_Charles\\_Pugin.jpg](https://upload.wikimedia.org/wikipedia/commons/c/cb/Augustus_Charles_Pugin.jpg) ; [https://upload.wikimedia.org/wikipedia/commons/thumb/4/47/Henry\\_Holland\\_%28architect%29.jpg/320px-Henry\\_Holland\\_%28architect%29.jpg](https://upload.wikimedia.org/wikipedia/commons/thumb/4/47/Henry_Holland_%28architect%29.jpg/320px-Henry_Holland_%28architect%29.jpg)

## 15.8 The "Crystal Palace" - Great Exhibition's palace, London, United Kingdom, 1851 (Arch. Joseph Paxton)

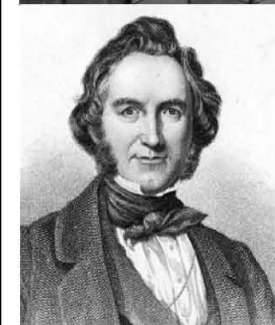
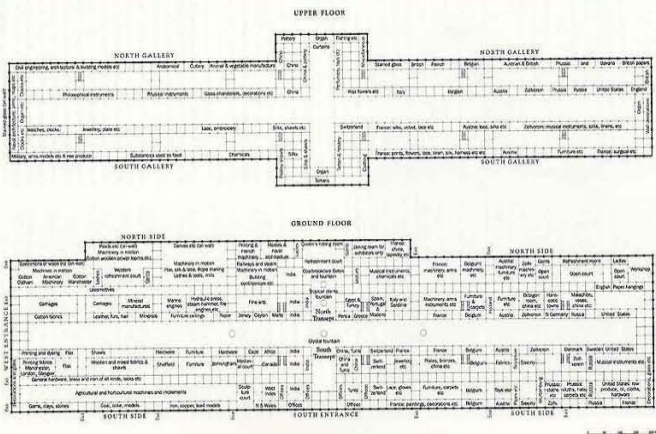
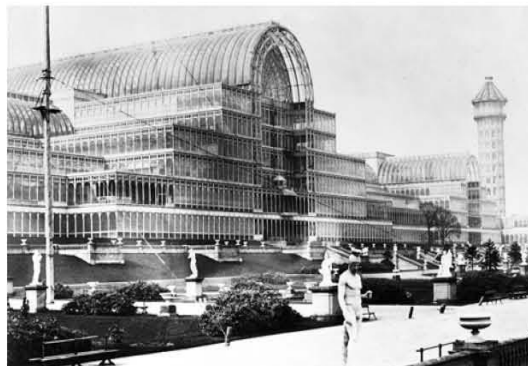

Sources: [http://www.lemog.fr/lemog\\_expo\\_v2/albums/documentation/autres\\_expo/pays\\_divers/cpa\\_crystal\\_palace\\_0574\\_800.jpg](http://www.lemog.fr/lemog_expo_v2/albums/documentation/autres_expo/pays_divers/cpa_crystal_palace_0574_800.jpg) ; <https://rentomod.files.wordpress.com/2013/04/paxton-crystalpalace.jpg> ; [http://images.adsttc.com/media/images/51d4/79f7/b3fc/4b9e/0f00/019b/large.jpg/800px-Crystal\\_Palace\\_-\\_plan.jpg?1372879349](http://images.adsttc.com/media/images/51d4/79f7/b3fc/4b9e/0f00/019b/large.jpg/800px-Crystal_Palace_-_plan.jpg?1372879349) ; <https://media1.britannica.com/eb-media/52/12552-004-4BDAFDC8.jpg> ; [https://upload.wikimedia.org/wikipedia/commons/e/eb/Crystal\\_Palace\\_interior.jpg](https://upload.wikimedia.org/wikipedia/commons/e/eb/Crystal_Palace_interior.jpg) ; [http://biber.co/assets/WORDS/ESSAYS/What-is-an-Expo/1230xAUTO\\_crop\\_center-center\\_85/1409128a01d49dd68038371cda49e92e.jpg](http://biber.co/assets/WORDS/ESSAYS/What-is-an-Expo/1230xAUTO_crop_center-center_85/1409128a01d49dd68038371cda49e92e.jpg) ; <http://images.fineartamerica.com/images-medium-large/sir-joseph-paxton-granger.jpg>



## 15.9 The Palace of Westminster / the Houses of Parliament, London, United Kingdom, 1860 (Arch. Charles Barry, Augustus Welby Northmore Pugin)

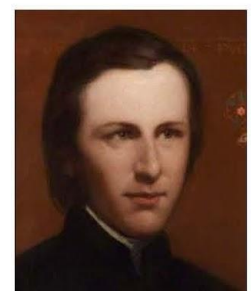
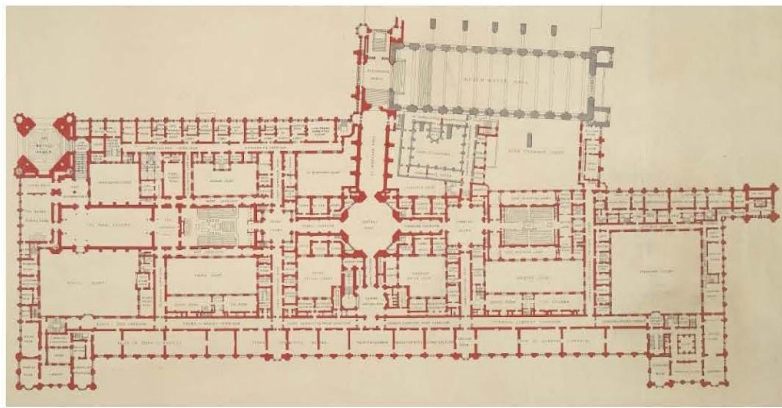

Sources: [https://upload.wikimedia.org/wikipedia/commons/thumb/4/42/London\\_Parliament\\_2007-1.jpg/1920px-London\\_Parliament\\_2007-1.jpg](https://upload.wikimedia.org/wikipedia/commons/thumb/4/42/London_Parliament_2007-1.jpg/1920px-London_Parliament_2007-1.jpg) ;  
[https://upload.wikimedia.org/wikipedia/commons/f/f5/Palace\\_of\\_Westminster\\_plan%2C\\_F\\_Crace%2C\\_high\\_resolution.png](https://upload.wikimedia.org/wikipedia/commons/f/f5/Palace_of_Westminster_plan%2C_F_Crace%2C_high_resolution.png) ;  
[https://upload.wikimedia.org/wikipedia/commons/thumb/3/3e/Victoria\\_Tower\\_from\\_Old\\_Palace\\_Yard.jpg/800px-Victoria\\_Tower\\_from\\_Old\\_Palace\\_Yard.jpg](https://upload.wikimedia.org/wikipedia/commons/thumb/3/3e/Victoria_Tower_from_Old_Palace_Yard.jpg/800px-Victoria_Tower_from_Old_Palace_Yard.jpg) ;  
[https://upload.wikimedia.org/wikipedia/commons/d/d0/Sir\\_Charles\\_Barry\\_by\\_John\\_Prescott\\_Knight.jpg](https://upload.wikimedia.org/wikipedia/commons/d/d0/Sir_Charles_Barry_by_John_Prescott_Knight.jpg) ;  
[https://upload.wikimedia.org/wikipedia/commons/thumb/8/82/Central\\_Tower%2C\\_Palace\\_of\\_Westminster.jpg/800px-Central\\_Tower%2C\\_Palace\\_of\\_Westminster.jpg](https://upload.wikimedia.org/wikipedia/commons/thumb/8/82/Central_Tower%2C_Palace_of_Westminster.jpg/800px-Central_Tower%2C_Palace_of_Westminster.jpg) ;  
[https://upload.wikimedia.org/wikipedia/commons/9/9f/Augustus\\_Welby\\_Northmore\\_Pugin\\_from\\_NPG.jpg](https://upload.wikimedia.org/wikipedia/commons/9/9f/Augustus_Welby_Northmore_Pugin_from_NPG.jpg)

**15.10 The United States Capitol, Washington, D.C., USA, 1800 / 1863  
(Arch. William Thornton)**

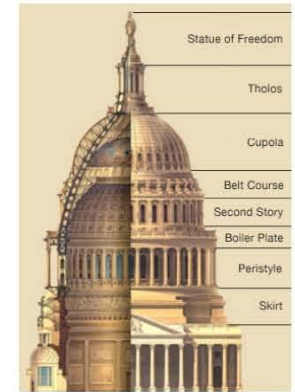
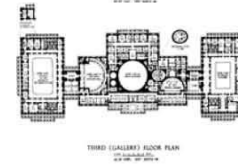
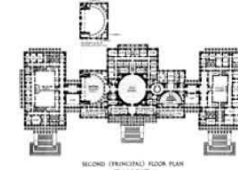
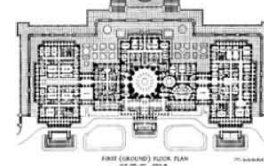
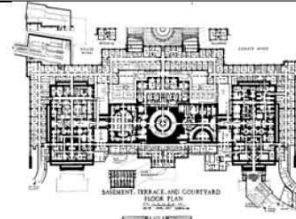

Sources: <https://upload.wikimedia.org/wikipedia/commons/1/1f/Aerial view of the Capitol Hill.jpg> ;  
<https://upload.wikimedia.org/wikipedia/commons/thumb/a/a3/United States Capitol west front edit2.jpg/1920px-United States Capitol west front edit2.jpg> ;  
<https://upload.wikimedia.org/wikipedia/commons/thumb/8/8c/US Capitol basement floor plan 1997 105th-congress.gif/1280px-US Capitol basement floor plan 1997 105th-congress.gif> ;  
<https://upload.wikimedia.org/wikipedia/commons/thumb/9/99/US Capitol first floor plan 1997 105th-congress.gif/1280px-US Capitol first floor plan 1997 105th-congress.g> ;  
<https://upload.wikimedia.org/wikipedia/commons/thumb/4/4f/US Capitol second floor plan 1997 105th-congress.gif/1280px-US Capitol second floor plan 1997 105th-congress.gif> ;  
<https://upload.wikimedia.org/wikipedia/commons/thumb/6/6c/US Capitol third floor plan 1997 105th-congress.gif/1280px-US Capitol third floor plan 1997 105th-congress.gif> ;  
<https://www.aoc.gov/sites/default/files/capitol-dome-diagram.jpg> ; <https://3f009b6523c0c1f8b94-091582592a5f780b4bac3b68414d35fd.ssl.cf5.rackcdn.com/default/destruction-united-states-capitol-01.jpg>



**Recommended educational and scientific-theoretical sources:**

1. Augustus Pugin / From Wikipedia, the free encyclopedia. - URL: [https://en.wikipedia.org/wiki/Augustus\\_Pugin](https://en.wikipedia.org/wiki/Augustus_Pugin)
2. Charles Barry / From Wikipedia, the free encyclopedia. - URL: [https://en.wikipedia.org/wiki/Charles\\_Barry](https://en.wikipedia.org/wiki/Charles_Barry)
3. Palace of Westminster / From Wikipedia, the free encyclopedia. - URL: [https://en.wikipedia.org/wiki/Palace\\_of\\_Westminster](https://en.wikipedia.org/wiki/Palace_of_Westminster)
4. United States Capitol / From Wikipedia, the free encyclopedia. - URL: [https://en.wikipedia.org/wiki/United\\_States\\_Capitol](https://en.wikipedia.org/wiki/United_States_Capitol)
5. William Thornton / From Wikipedia, the free encyclopedia - URL: [https://en.wikipedia.org/wiki/William\\_Thornton](https://en.wikipedia.org/wiki/William_Thornton)
6. Architect of the Capitol / From Wikipedia, the free encyclopedia. - URL: [https://en.wikipedia.org/wiki/Architect\\_of\\_the\\_Capitol](https://en.wikipedia.org/wiki/Architect_of_the_Capitol)
7. Palace of Versailles / From Wikipedia, the free encyclopedia. - URL: [https://en.wikipedia.org/wiki/Palace\\_of\\_Versailles](https://en.wikipedia.org/wiki/Palace_of_Versailles)
8. Louis Le Vau / From Wikipedia, the free encyclopedia. - URL: [https://en.wikipedia.org/wiki/Louis\\_Le\\_Vau](https://en.wikipedia.org/wiki/Louis_Le_Vau)
9. Sanssouci / From Wikipedia, the free encyclopedia. - URL: <https://en.wikipedia.org/wiki/Sanssouci>
10. Georg Wenzeslaus von Knobelsdorff / From Wikipedia, the free encyclopedia. - URL: [https://en.wikipedia.org/wiki/Georg\\_Wenzeslaus\\_von\\_Knobelsdorff](https://en.wikipedia.org/wiki/Georg_Wenzeslaus_von_Knobelsdorff)
11. Zwinger (Dresden) / From Wikipedia, the free encyclopedia. - URL: [https://en.wikipedia.org/wiki/Zwinger\\_\(Dresden\)](https://en.wikipedia.org/wiki/Zwinger_(Dresden))
12. Matthäus Daniel Pöppelmann / From Wikipedia, the free encyclopedia. - URL: [https://en.wikipedia.org/wiki/Matth%C3%A4us\\_Daniel\\_P%C3%B6ppelmann](https://en.wikipedia.org/wiki/Matth%C3%A4us_Daniel_P%C3%B6ppelmann)
13. Gottfried Semper / From Wikipedia, the free encyclopedia. - URL: [https://en.wikipedia.org/wiki/Gottfried\\_Semper](https://en.wikipedia.org/wiki/Gottfried_Semper)
14. The Crystal Palace / From Wikipedia, the free encyclopedia. -URL: [https://en.wikipedia.org/wiki/The\\_Crystal\\_Palace](https://en.wikipedia.org/wiki/The_Crystal_Palace)
15. Joseph Paxton / From Wikipedia, the free encyclopedia. - URL: [https://en.wikipedia.org/wiki/Joseph\\_Paxton](https://en.wikipedia.org/wiki/Joseph_Paxton)
16. Royal Pavilion / From Wikipedia, the free encyclopedia. - URL: [https://en.wikipedia.org/wiki/Royal\\_Pavilion](https://en.wikipedia.org/wiki/Royal_Pavilion)

17. John Nash (architect) / From Wikipedia, the free encyclopedia. - URL:  
[https://en.wikipedia.org/wiki/John\\_Nash\\_\(architect\)](https://en.wikipedia.org/wiki/John_Nash_(architect))
18. Augustus Charles Pugin / From Wikipedia, the free encyclopedia. - URL:  
[https://en.wikipedia.org/wiki/Augustus\\_Charles\\_Pugin](https://en.wikipedia.org/wiki/Augustus_Charles_Pugin)
19. Henry Holland (architect) / From Wikipedia, the free encyclopedia. - URL:  
[https://en.wikipedia.org/wiki/Henry\\_Holland\\_\(architect\)](https://en.wikipedia.org/wiki/Henry_Holland_(architect))
20. William Porden / From Wikipedia, the free encyclopedia. - URL: [https://en.wikipedia.org/wiki/William\\_Porden](https://en.wikipedia.org/wiki/William_Porden)
21. Museodel Prado / From Wikipedia, the free encyclopedia. - URL: [https://en.wikipedia.org/wiki/Museo\\_del\\_Prado](https://en.wikipedia.org/wiki/Museo_del_Prado)
22. Juan de Villanueva / From Wikipedia, the free encyclopedia. - URL:  
[https://en.wikipedia.org/wiki/Juan\\_de\\_Villanueva](https://en.wikipedia.org/wiki/Juan_de_Villanueva)
23. Mexico City Metropolitan Cathedral / From Wikipedia, the free encyclopedia. - URL:  
[https://en.wikipedia.org/wiki/Mexico\\_City\\_Metropolitan\\_Cathedral](https://en.wikipedia.org/wiki/Mexico_City_Metropolitan_Cathedral)
24. La Madeleine, Paris / From Wikipedia, the free encyclopedia. - URL:  
[https://en.wikipedia.org/wiki/La\\_Madeleine,\\_Paris](https://en.wikipedia.org/wiki/La_Madeleine,_Paris)

## Briefly about the Author



# Konstantin I.SAMOILOV

High Doctorate (Arch) – 2008,  
Doctor of Sciences (Arch) – 2004,  
Candidate of Sciences / eq. PhD(Arch) – 1990,  
Dipl.Arch. / eq. MArch – 1983,  
Dipl.Tech.Arch. / eq. BArch – 1977



**Associate Professor of the Architectural Faculty –**  
Kazakh Leading Academy of Architecture and Civil Engineering –  
**[www.kazgasa.kz](http://www.kazgasa.kz)**

E: [samconiv@yahoo.com](mailto:samconiv@yahoo.com) , [samconiv@mail.ru](mailto:samconiv@mail.ru)

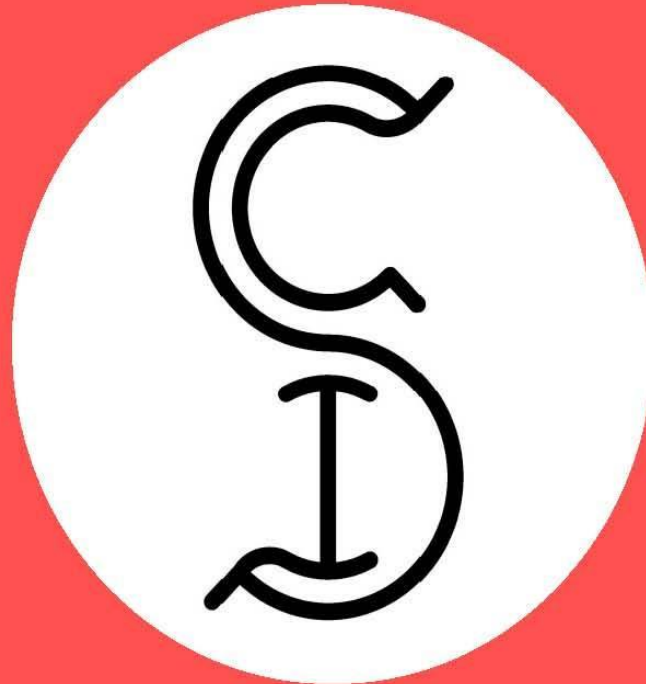

THE HISTORY OF ARCHITECTURE FROM PREHISTORIC TO MODERN TIMES:  
Albums of characteristic examples for the Educational course / by Dr. Konstantin I.Samoilov. –  
The fifteenth Album: THE WESTERN EUROPEAN AND THE NORTH AMERICAN NEW TIMES  
ARCHITECTURE. – Almaty, 2017. – 19 p.