



FRANK LLOYD WRIGHT

ORGANIC ARCHITECTURE

Выполнила студентка
ДН-191
Суюндикова Ф.

FRANK LLOYD WRIGHT

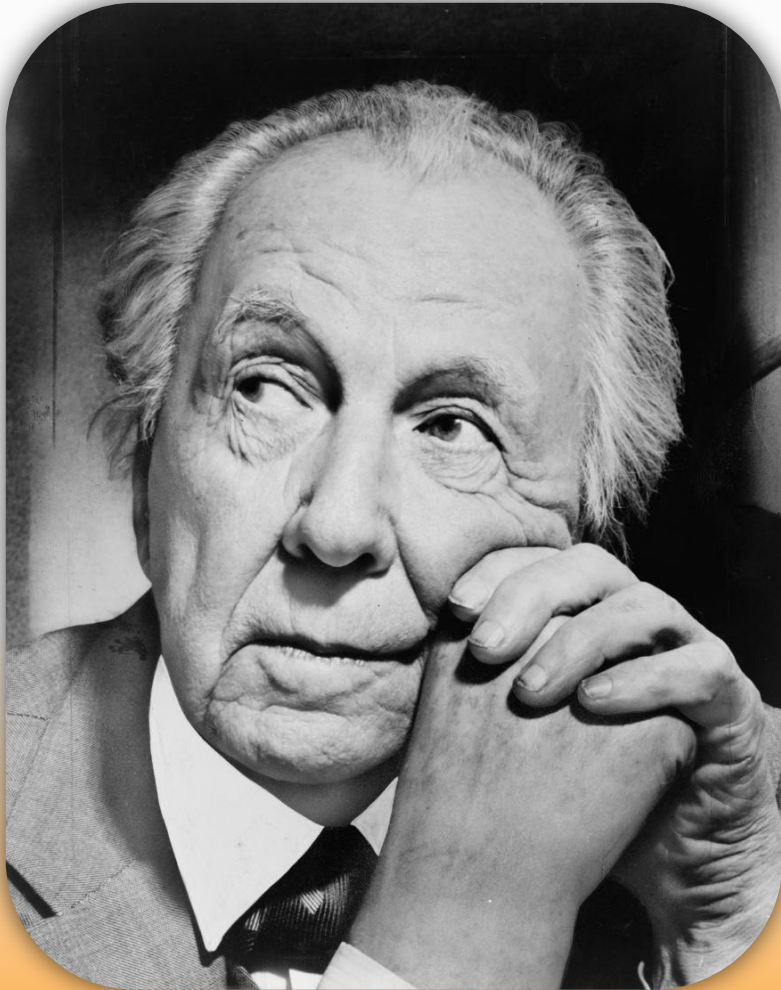

- Frank Lloyd Wright is an American pioneer architect.
- He had a huge impact on the development of Western architecture in the first half of the twentieth century.
- Wright created organic architecture and promoted open plan architecture.

SHARING OUR STORY

- From before Fallingwater was designed to when it was opened to the public for tours, there is a deep and rich history of the people, design, construction and relevance of Fallingwater.





HOUSE FALLINGWATER

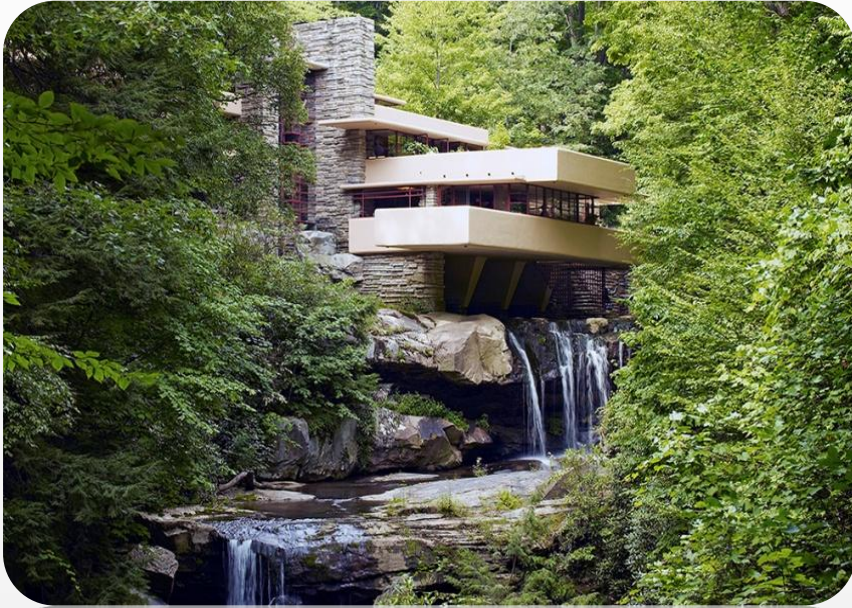

- House Fallingwater is a real masterpiece of organic architecture. This amazing house, which is located in Pennsylvania, was built according to the order of Pittsburgh businessman Kaufman.

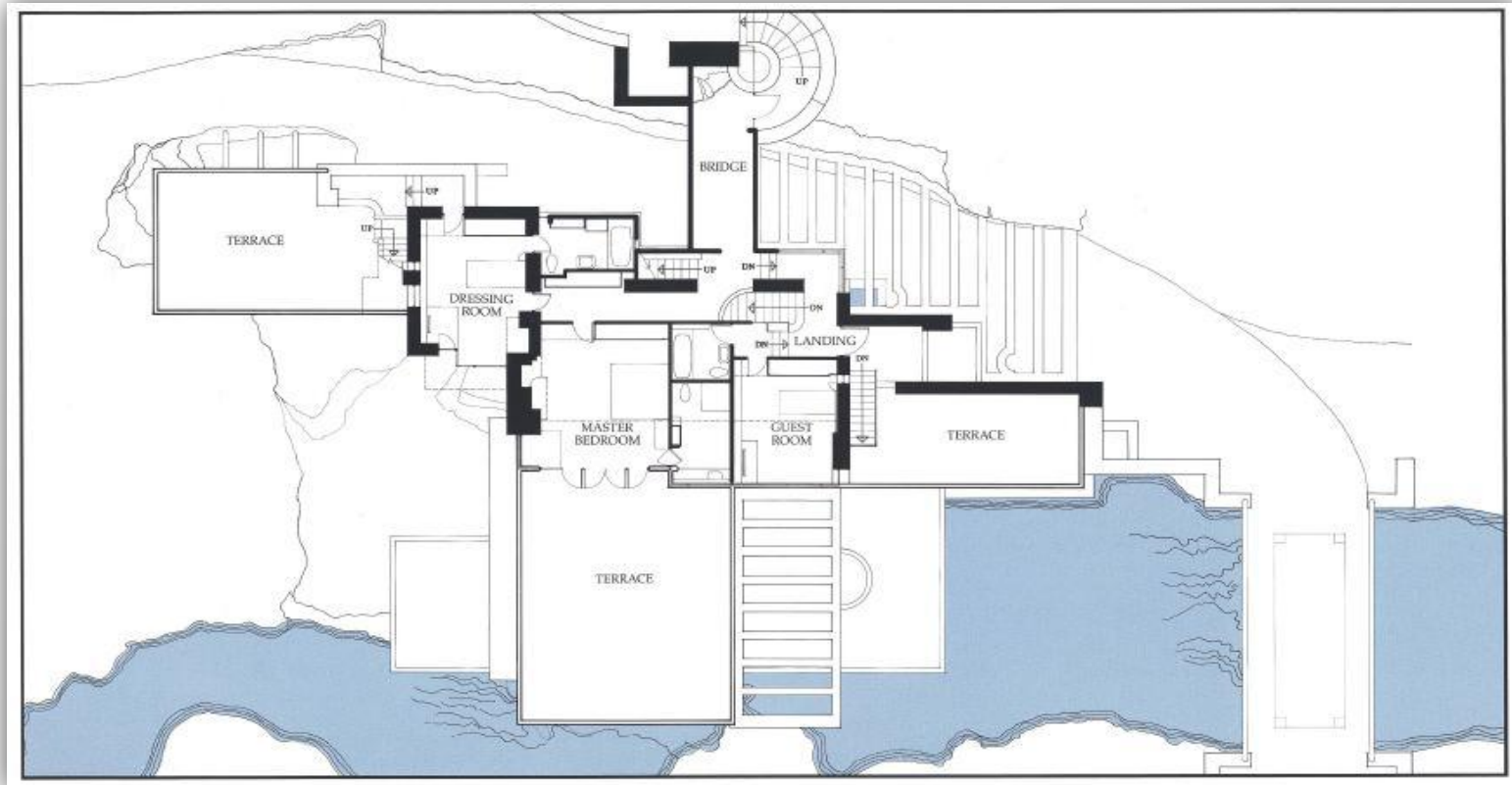

- The house on the waterfall was built in a very bold and innovative form.
- Fallingwater is a composition of concrete decks and vertical surfaces of limestone, located on steel posts directly over the stream.

- Walls were placed on a concrete pad platform. They grew from the ground and ended at the level of the second floor.
- The roof had a small slope. The underside of roof overhangs is painted in bright colors.



THE INTERIOR OF THE HOUSE

- The interior of the house is fully open, the curtains are missing, allows you to fill the house with sunlight.
- From the console part of the living room a staircase descends directly to the stream at the bottom.
- Floors in the living room are polished part of the rock on which the house is situated. Plaster is missing, and a lot of wood is used in the lining of the walls and ceiling.



- The first floor of the house is a great room with adjoining kitchen, hallway and dining room. The room goes into terraces, merging with nature, thanks all the same solid ostekleniya in the living room, built of boulders.
- Natural stone floors are polished. The boulders from which the fire-place is created in the living room, are left untouched.





- The second floor houses three bedrooms, each is on its separate balcony. In the small house the ceilings is fairly low.
- Wright himself designed interior design, including furniture and carpets.



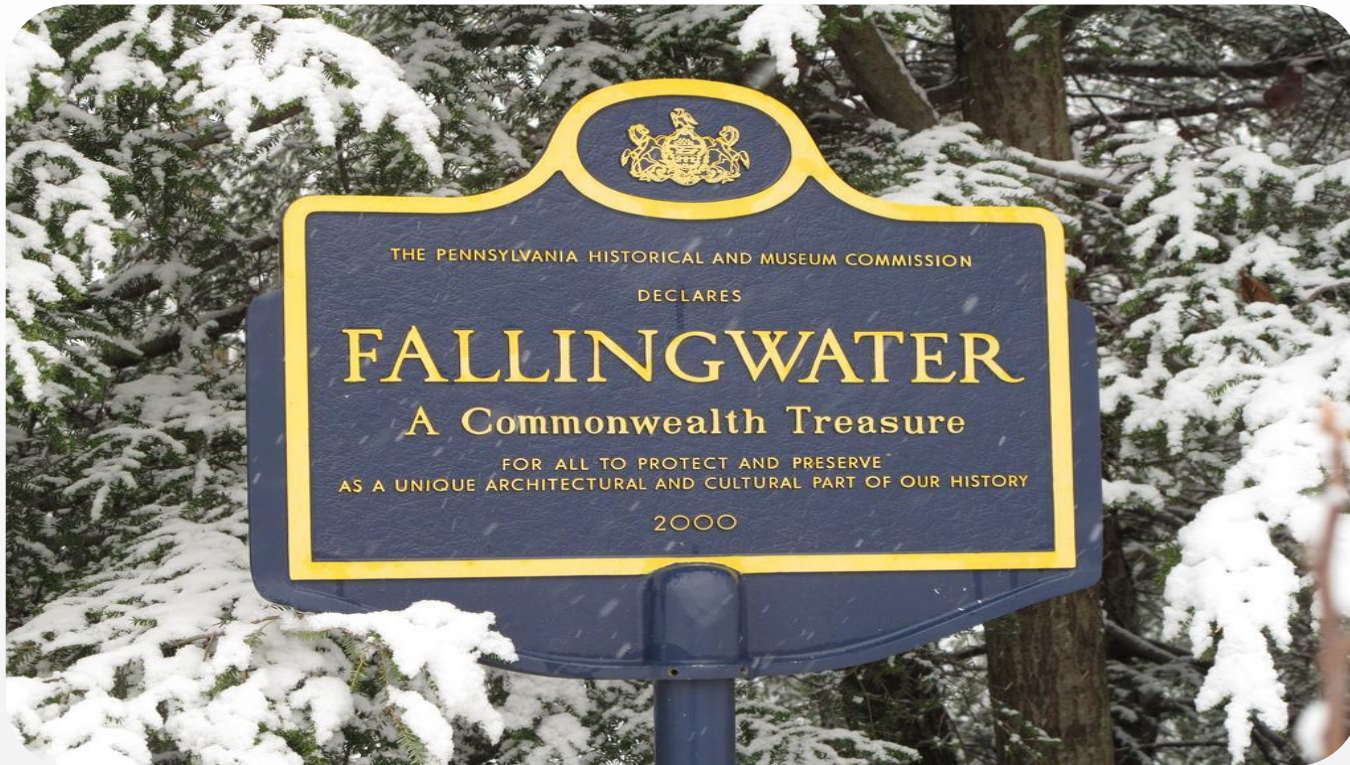

- The house on the waterfall is one of the most well-known private houses of the twentieth century.
- American architect Frank Wright began the construction of the building in 1934, in October 1937 it was completed.